



*jordan fishwick*

15 Green Hall Mews, SK9 1LP  
Guide Price £249,950



## Green Hall Mews Wilmslow SK9 1LP

Guide Price £249,950



NO CHAIN. A two bedroom first floor modern apartment located within the centre of Wilmslow. The property is a short walk away from Wilmslow centre which offers a wide range of amenities, including a number of local shopping facilities, bars, restaurants, local leisure centre and with Wilmslow train station offering a direct service to London Euston and Manchester City centre the location caters for many different needs. Within a 10 minute drive away there are many additional amenities such as fitness centres, golf courses, Marks and Spencer and John Lewis. The property is well placed for easy access to the M56 for commuters to Manchester and the North West commercial centres and Manchester Airport is less than 20 minutes away. The accommodation in brief comprises, a well maintained communal entrance hallway leading to the private entrance hall of the apartment which provides access to two generous double bedrooms and a three piece family bathroom suite with over-bath shower. The large living dining space provides excellent space for entertaining and leads to the kitchen which provides matching wall and base fitted units and a handful of integrated appliances. Externally, the apartment benefits from a garage, perfect for storage and an allocated parking space. Viewings essential.



- No Chain
- Two Bedroom Apartment
- Central Wilmslow Location
- Open Living Dining Area
- Family Bathroom
- Garage
- Allocated Parking



Energy Efficiency Rating		
	Current	Potential
Very energy efficient - lower running costs		
(92 plus) <b>A</b>		
(81-91) <b>B</b>		
(69-80) <b>C</b>	72	80
(55-68) <b>D</b>		
(39-54) <b>E</b>		
(21-38) <b>F</b>		
(1-20) <b>G</b>		
Not energy efficient - higher running costs		
<b>England &amp; Wales</b>	EU Directive 2002/91/EC	

## GROUND FLOOR

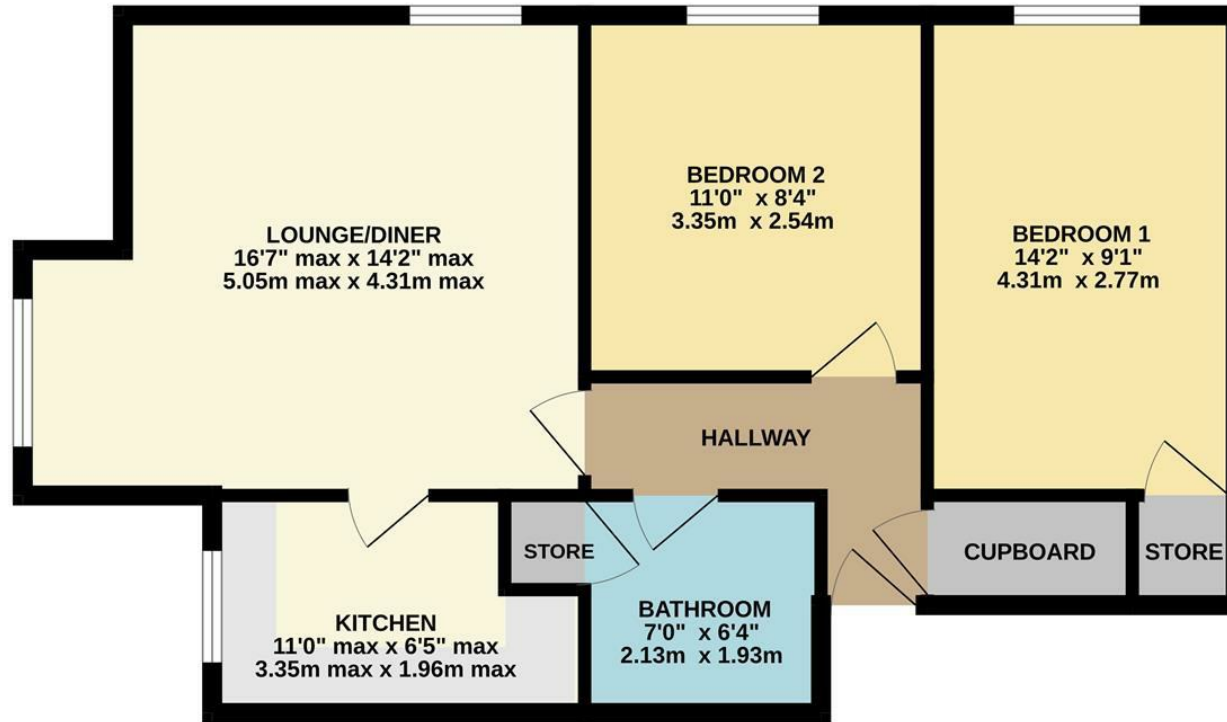

Measurements are approximate. Not to scale. Illustrative purposes only  
Made with Metropix ©2025



These particulars are believed to be accurate but they are not guaranteed and do not form a contract. Neither Jordan Fishwick nor the vendor or lessor accept any responsibility in respect of these particulars, which are not intended to be statements or representations of fact and any intending purchaser or lessee must satisfy himself by inspection or otherwise as to the correctness of each of the statements contained in these particulars. Any floorplans on this brochure are for illustrative purposes only and are not necessarily to scale.

Offices at: Chorlton, Didsbury, Disley, Hale, Glossop, Macclesfield, Manchester Deansgate, Manchester Whitworth Street, New Mills, Sale, Wilmslow and Withington

36-38 Alderley Road, Wilmslow SK91JX  
**01625 532000**

wilmslow@jordanfishwick.co.uk  
www.jordanfishwick.co.uk